

# visionary™ DESIGNS

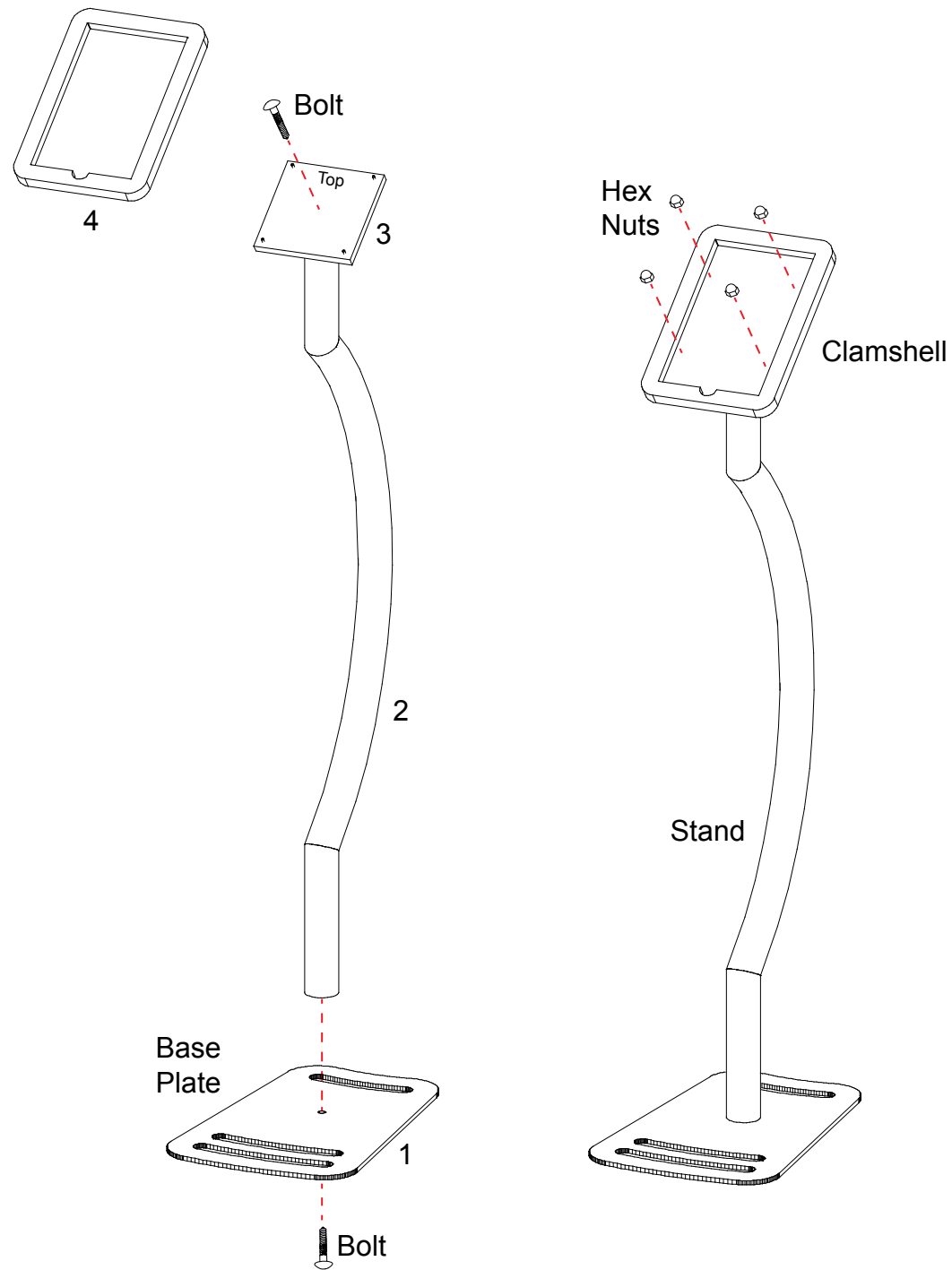

**Steps:**

- 1) Attach base [1] to curved vertical [2] using bolt.
- 2) Attach square plate [3] to vertical [2] using bolt.  
*NOTE: Square plate [3] must rotate to left and right before installing clamshell*
- 3) Attach clamshell [4] to square plate [3] using hex nuts.
- 4) Insert iPad and feed wire through hole.

**Tools Required:**

- 1) Hex Tool
- 2) Pliers

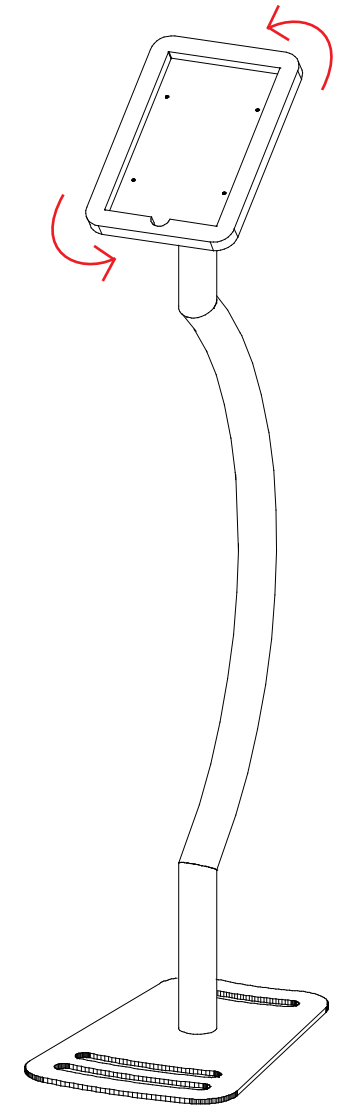
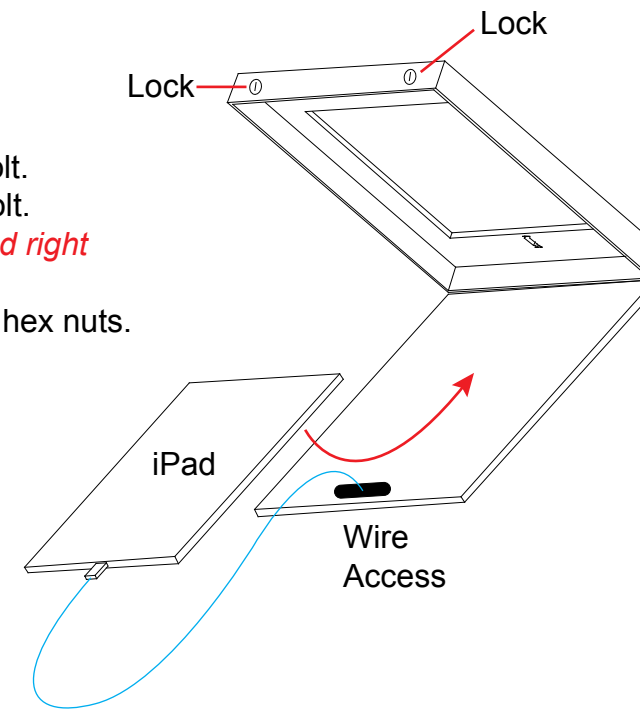

**Wire Management for iPad**



Feed iPad charging cord through holes from top to bottom of post as shown.

**Optional Cover for Home Button**

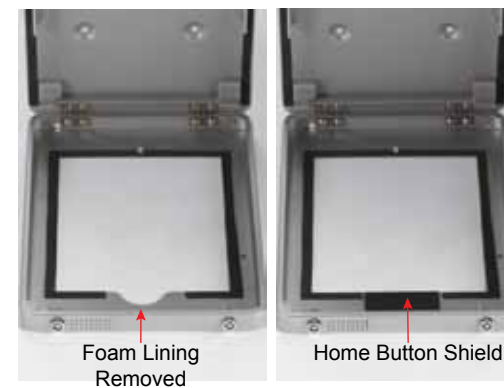

- 1) Remove foam lining from inside bottom of clamshell as shown.
- 2) Attach Home Button Shield with double-sided tape to inside of clamshell, keeping top of shield flush with clamshell opening as shown.

**NOTE:** This is a permanent fix and can't be easily removed.

WHEN DISASSEMBLING, TIGHTEN ALL SCREWS AND NUTS TO PREVENT LOSS DURING SHIPPING.